



INNOVATION



STYLE



PERFORMANCE

POLYPOOLTM

INSULATED SWIMMING POOLS





THE ULTIMATE SWIMMING POOL

You may be considering investing in a swimming pool for a number of reasons...

- Time to relax and unwind after a stressful day
- Quality time with friends and family
- Retreat from the summer heat
- Exhilarating start to the day
- Rehabilitation after an illness or accident
- Encouraging children to learn to swim
- Improving your health and fitness

Whatever your reasons, owning a Polypool is quite simply a lot of fun and will open up a whole new way of life for you, your family and friends, all in the comfort of your own home.





IMPROVE YOUR LIFESTYLE



'We have been at the forefront of swimming pool design for over ten years'

We strongly believe that owning a swimming pool will change your life. It is an investment in your quality of life as well as an investment in the value of your home. Fun and relaxation combined with exercise for the family will help promote a healthier lifestyle year after year.

In the UK's climate, we understand that anyone looking to invest in a pool, indoors or outdoors, will need to maximise its use. Polypool has developed and patented its own unique insulated heat retaining panels, guaranteeing unbelievable energy savings while sustaining warm water temperatures.





ENJOY YOUR POOL IN UNDER 20 DAYS!

Polypool supply all the mechanical and ancillary equipment you will need - pumps, heating and filtration systems for all pool sizes and situations - and we are constantly monitoring and updating specifications as technology develops.

Day 1



clear site and marking out

Day 2



excavation as per drawing

Day 4



check levels and construct pool

Day 5



installing the insulated panels



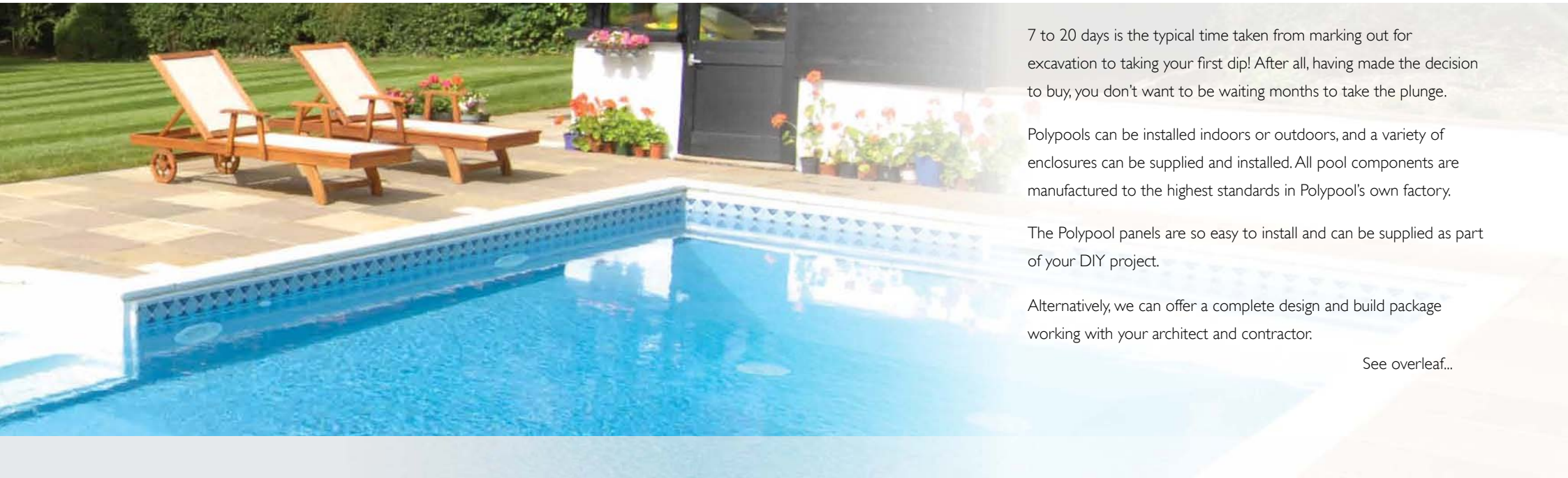

7 to 20 days is the typical time taken from marking out for excavation to taking your first dip! After all, having made the decision to buy, you don't want to be waiting months to take the plunge.

Polypools can be installed indoors or outdoors, and a variety of enclosures can be supplied and installed. All pool components are manufactured to the highest standards in Polypool's own factory.

The Polypool panels are so easy to install and can be supplied as part of your DIY project.

Alternatively, we can offer a complete design and build package working with your architect and contractor.

See overleaf...

Day 6



pool structure built

Day 8



screeding pool

Day 16



clean site and vacuum underfelt

Day 16



apply the liner

Day 20



completed pool

'Remember, the choice is yours - professional or self build, it's up to you'

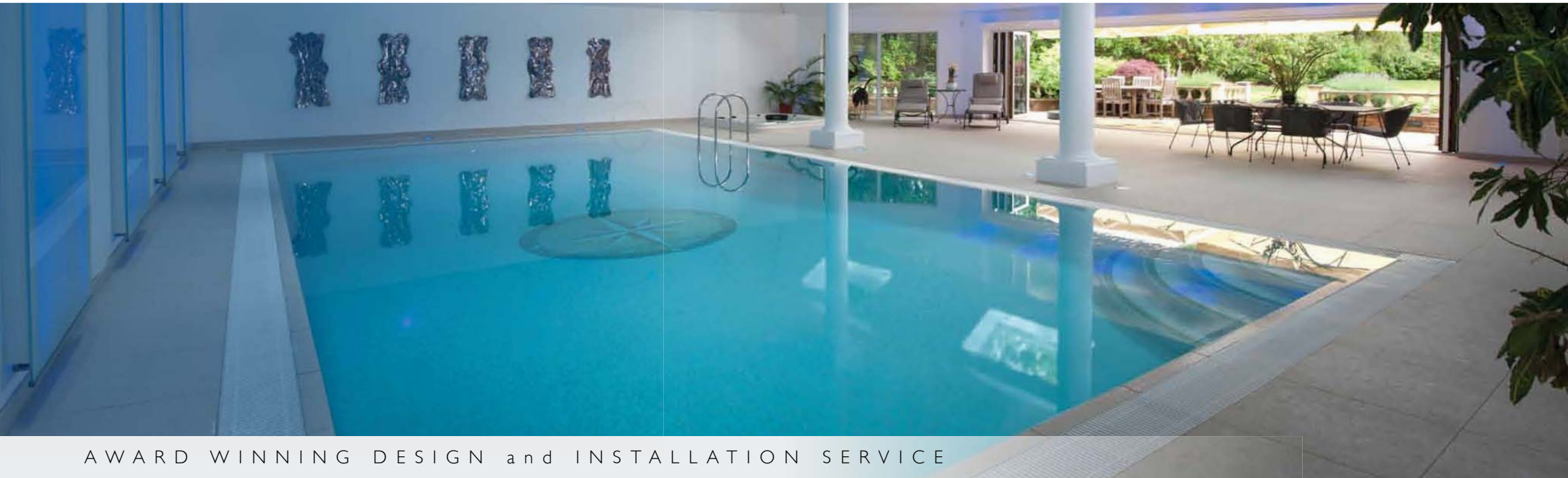

AWARD WINNING DESIGN and INSTALLATION SERVICE

The brief

This particular scheme was a joint venture between the client, their architect, a main contractor and Polypool Ltd as the designated swimming pool contractor. This required a high level of communication between the various parties on site to ensure the smooth running of the project. The areas of responsibility were as follows:

- Polypool Ltd to liaise with architect in order to specify swimming pool, plant and relevant materials inside the pool hall
- Main contractor to erect building to supplied specification
- Main contractor to carry out all groundwork (excavation, backfill, floor screed, oversight, pool surround and finishes inside the building etc) as per Polypool specification agreed with architect
- Polypool Ltd to design, specify, supply and install the swimming pool, sauna and spa including all electrical and mechanical plant equipment and commissioning/hand over etc
- Polypool Ltd were also tasked with the project management element of the pool hall construction





The specification

- 12m x 6m Polypool heat-retaining panel system
- 1.5m depth (with deep end)
- Integral Polypool corner step unit
- Environmental recovery system control unit with fresh air supply ducting to windows around the pool hall perimeter
- Tiled pool surround flush to pool edge
- 100 % chlorine free sanitisation system
- Sauna, showers and spa



Testimonial

I have to admit that I was reluctant to have a pool incorporated into the changes to our home but was persuaded by my wife to do so. This was on the basis that I thought the pool would be a considerable amount of work to maintain, and would be just another complication in our already busy lives.

However I have completely changed my views, and feel that the pool we have has enormously increased its attractiveness. I spend very little time in maintenance, as it has incorporated all the latest techniques, which means to a large extent self regulates.

It looks superb, and we are absolutely delighted with the end result.

IT WORKS - SIMPLY and EFFECTIVELY



One of the laws of physics states that heat will flow from a warm body to a cold one.

All pools in the same location will lose the same amount of heat from the surface. The construction of the walls and floor will make a big difference regarding heat loss.

Our diagram opposite demonstrates the heat cycle within our insulated pool system. There are two options on offer: Our 125mm panel system is the ultimate in heat retention with the highest U values on the market whilst our 75mm panel system offers affordability and heat retention figures that rival any traditionally built swimming pool.

Read the facts for yourself.

Our patented insulated heat retaining panel can save you up to 98% of the heat lost through the walls compared to a conventionally built pool.

A wide choice of liners and tiles means you can tailor the look of your pool exactly to your taste.

A shaped concrete screed base will allow you to vary the depth of your pool giving you more control.

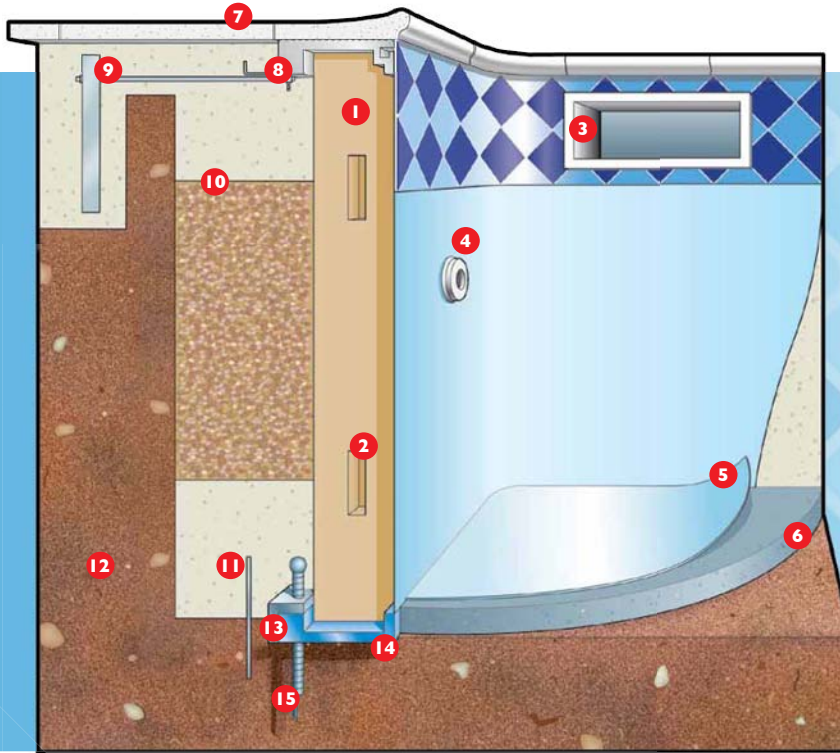

The figures

- 1.** Patented heat retaining thermal wall panel
- 2.** Panel clamp key locking mechanism
- 3.** Skimmer
- 4.** LED Light
- 5.** Large selection of liners and tile bands or mosaic tiles available
- 6.** Screed
- 7.** Coping stones or Timbertech edging
- 8.** Top channel
- 9.** Concrete oversite
- 10.** Pea shingle backfill
- 11.** Bottom concrete ringbeam
- 12.** Earth
- 13.** Bottom channel shoe
- 14.** Bottom channel
- 15.** Steel rod

*insulation floor packs available on all pools as an optional extra

Traditionally constructed pools, such as block and concrete shell, dissipate heat into the surrounding soil under and around the pool, continuously and constantly, this occurs when the surrounding soil is dry but when the water table is high, the pool's construction becomes saturated and the thermal efficiency drops even further.

But not through Polypool's uniquely insulated wall and floor panels. The heat retaining panels are designed to trap heat in the pool and keep the surrounding cold out.

By restricting the loss of heat through the pool walls and floor, our patented heat retaining panels act as a thermal break

- keeping more of your heat in and preventing the outside ground temperature extracting heat from the pool water resulting in dramatic energy savings and sustained warm water.

The result - a reduction in running costs year after year.



Thermal panel production

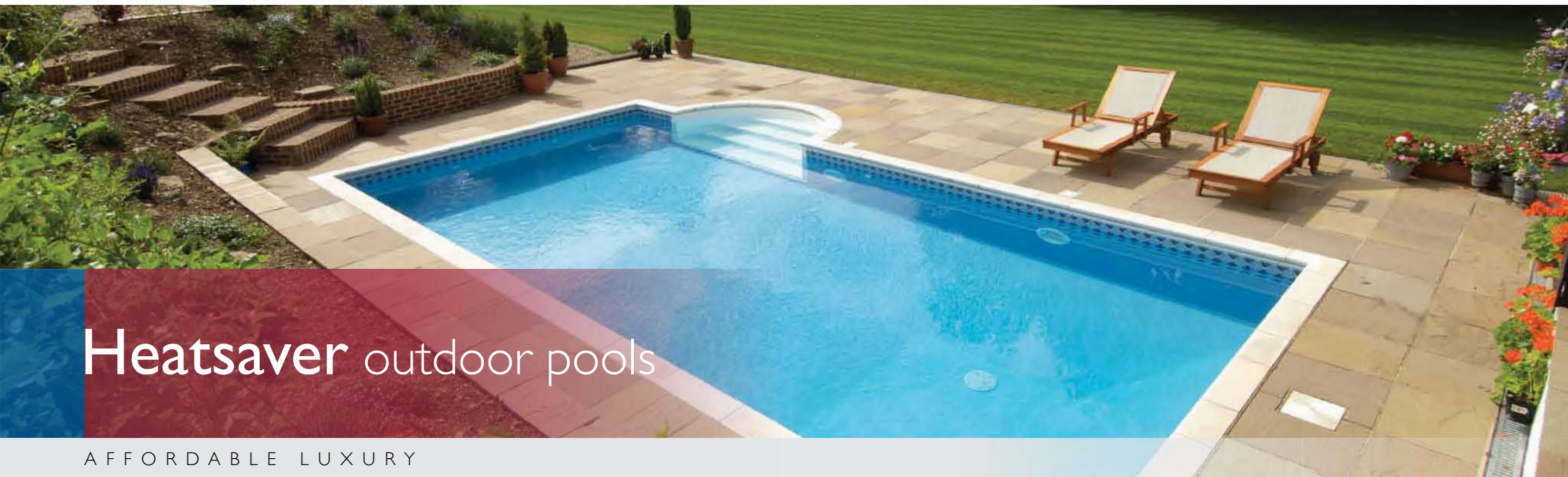

Heatsaver outdoor pools

A F F O R D A B L E L U X U R Y

The Polypool Heatsaver outdoor pool range offers a very efficient and affordable option with unrivalled energy savings.

The insulated panels used for the construction of our outdoor pools are available in two thicknesses, either 75mm or 125mm.

Our 75mm Heatsaver Polypool with a PVC liner is the ideal family pool for outdoor swimming from May - September and delivers maximum speed of installation and lower running costs making it unbeatable value for money.

The thicker 125mm panel gives even more insulation so even greater savings on running costs with an extended guarantee and the option to tile or use PVC liner.

When you take the savings of easier, faster construction and the year on year savings on running costs, there really is no other pool system on the market to rival Polypool's Heatsaver.



“The pool is fabulous; Polypool and Poolcare have been brilliant with their advice and support. Polypool made a complex project easy; they were always at the end of the phone if we had a query”

Carol and Richard Finn



In the UK's climate, we understand that anyone looking to invest in an outdoor swimming pool will need to maximise its use. That's why Polypool have developed and patented its own unique system of insulated, heat-retaining panels, to guarantee you unbelievable energy savings whilst sustaining warm water temperatures.

The unique interlocking wall panel system reduces the size of the excavation required, saving time and expense on backfilling,

Each panel is pre-plumbed to further speed up the installation time, which also makes it a viable DIY project.

Our outstanding choice of liner or tiled finishes, steps, pool surrounds, heating, ventilation and filtration systems supported by a lifetime of industry experience make Polypool the ideal choice for you and your family.

"We have had an excellent summer with our new pool, it has been absolutely fantastic. Thank you for helping us realise our dream!"

Nick & Elizabeth S.
Salisbury



Outdoor pools

Application:

- Domestic outdoor pool
- Commercial outdoor pool
- Plunge pool

Features:

75mm panels

- 15 year guarantee
- 75mm of polyurethane
- U-value 0.22
- HP 200 plastic panel finish
- Camlock panels
- 200mm overdig
- Factory fitted fittings as standard

125mm panels

- 25 year guarantee
- 125mm of polyurethane
- U-value 0.18
- HP200 plastic finish
- Camlock panels
- 375mm overdig
- Factory fitted fittings
- Option to tile



Manual pool roller & solar covers

Heatsaver 75mm panels

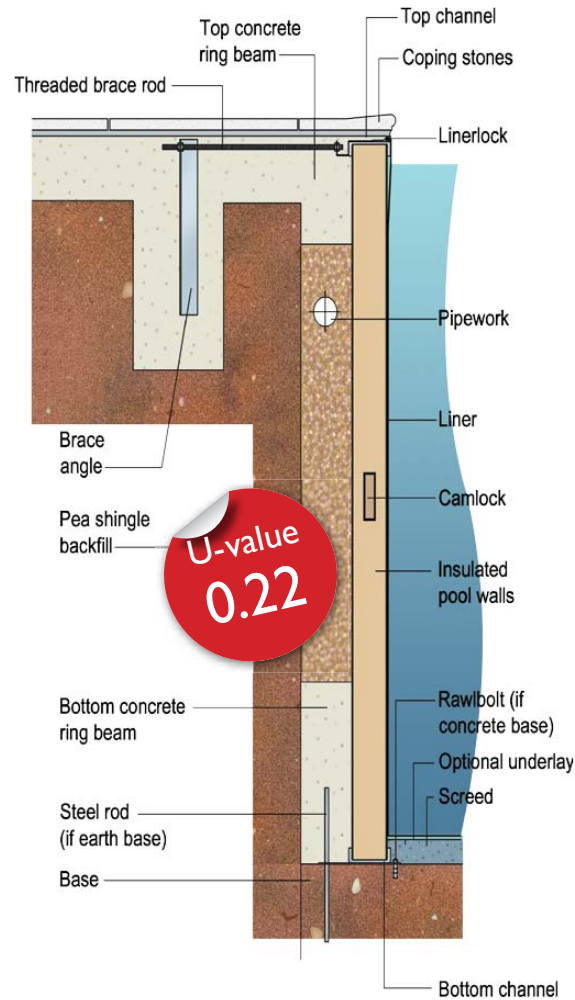

Heatsaver Plus 125mm panels

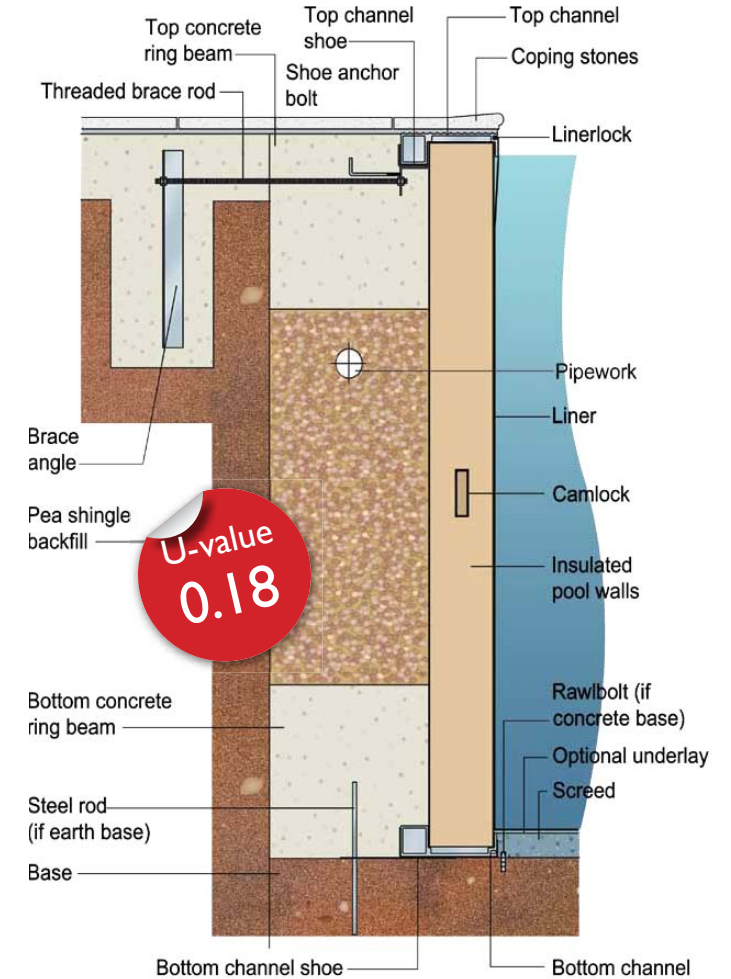



AUTOMATIC SAFETY COVER

Things to consider...

- Lighting - we can offer white or coloured LED lights
- Steps - we have a selection of styles to choose from
- Covers & rollers - choose from our vast selection of solar blankets, debris covers and automatic safety covers
- Heating - we can advise you on our range of heating options depending on your power source
- Water quality - our chlorine free system keeps your water crystal clear
- Automatic water top up - keeps your water at a constant level by replenishing water lost through evaporation and backwash
- Control Panel - our panels are build built to your specification, giving you complete control at your fingertips
- Cleaning & Maintenance - we have a wide choice of manual and automatic cleaners and offer advice on regular maintenance

POLYPOOL outdoor

This chart represents the total heat lost in watts through the walls and floor.

pool section and surrounding conditions	conventional construction	Polypool 75mm thermal panel system
dry conditions (walls)	79 watts per m2 per hour	5 watts per m ² per hour
dry conditions (floor)	27 watts per m2 per hour	5 watts per m ² per hour
wet conditions (walls)	140 watts per m2 per hour	5 watts per m ² per hour
wet conditions (floor)	97 watts per m2 per hour	5 watts per m ² per hour

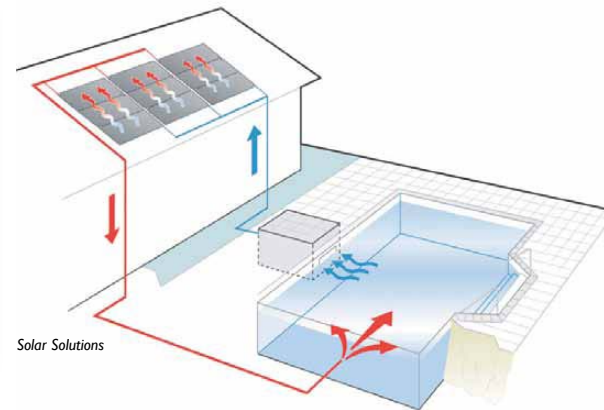

Solar Solutions



Heat loss is a key factor when planning and running a swimming pool. Restricting heat loss through the walls & flooring is essential in the economic running of a pool.



Platinum indoor pools

THE ULTIMATE IN HEAT RETENTION

All our indoor pools comply with the new Part L building regulations.

Our Polypool Platinum system with its original patent is the ultimate swimming pool in heat retention, offering huge savings compared to traditional construction methods.

The Platinum, with its insulated floor and wall structure complying with Part L building regulations, is highly recommended for all indoor swimming pool projects. The 125mm thick panel with its higher density of foam adds to its structural integrity allowing maximum versatility in all swimming pool applications. This technology allows us to custom-build your pool to any size or depth on the market to rival a Platinum Pool.

When you take the running costs coupled with easier, faster installation methods there really is no competitor on the market to rival a Platinum Polypool.





“We were really pleased with all the help and support from the team at Polypool and would welcome any new customers to have a look at our pool”

**Ruth
Scotland**



Choice of interior finishes

We can advise you on all aspects of heating and ventilation and will design and build an environmental control system specifically for your indoor pool project.

The environmental system provides efficient humidity control, active heat recovery and both air and pool water heating - all from a single, easily installed unit which is compatible with all types of heating.

Indoor pools

Application:

- Domestic Indoor pool
- Domestic outdoor pool
- Commercial pool
- Hydrotherapy pool
- Aqua Dive tanks (requires water depth in excess of 3m)
- Diving pools

Features:

- 25 year guarantee
- Galvanised steel faced panel
- 125 mm of polyurethane
- U-value 0.18 High insulation value
- HP 200 plastic panel finish
- Camlock panels
- 375 mm overdig
- Factory fitted fittings as standard
- Built in liner lock
- Reinforced top and bottom channel

Polypool Platinum - complete insulated pool structure

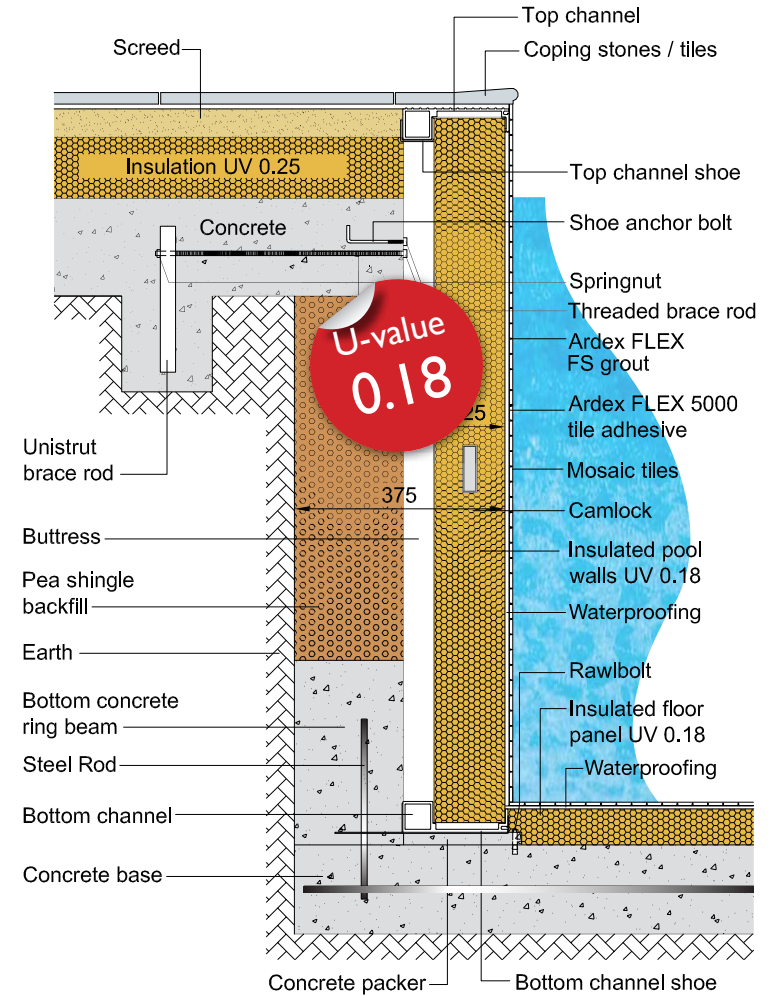

Effective heating and ventilation

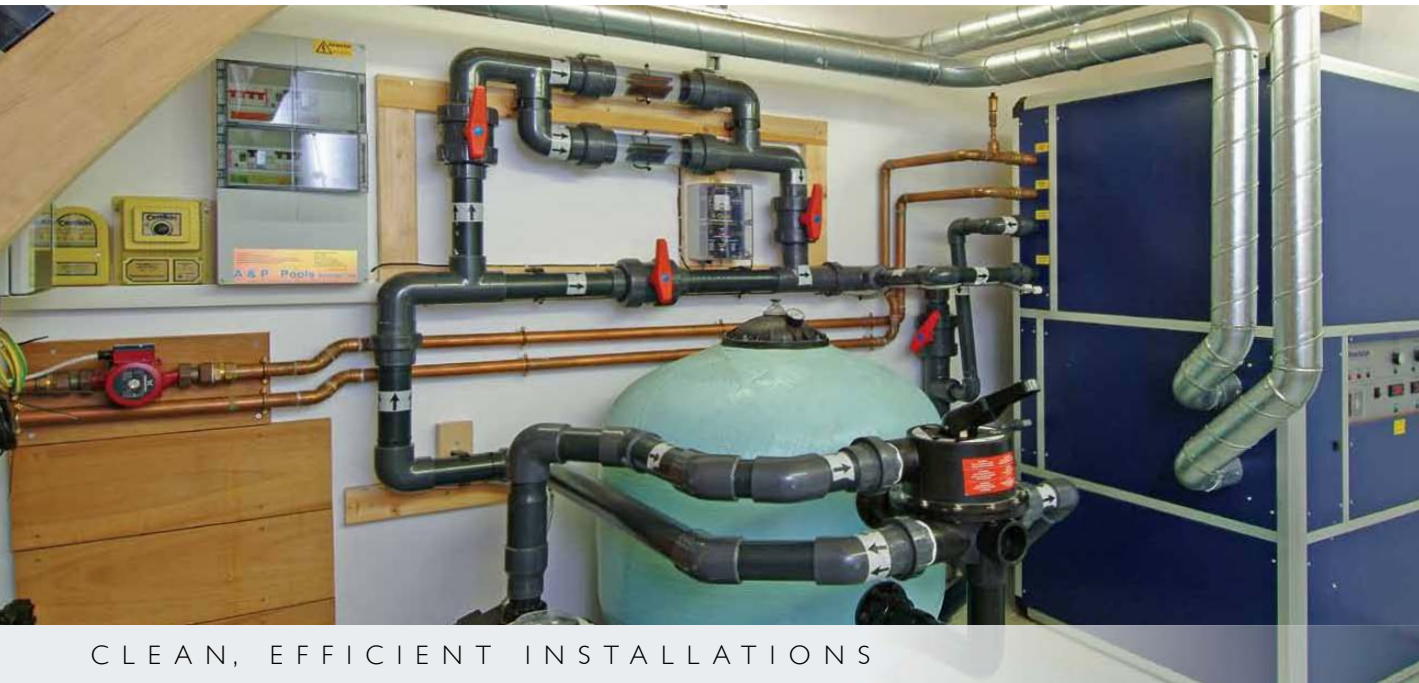

CLEAN, EFFICIENT INSTALLATIONS

Things to consider...

- Lighting - we can offer white or coloured LED lights
- Steps - we have a selection of styles to choose from
- Covers & rollers - choose from our vast selection of solar blankets, debris covers and automatic safety covers
- Heating & Ventilation - we have a selection of heating options and environmental units which are built to your specification to ensure optimum efficiency
- Water quality - our chlorine free system keeps your water crystal clear
- Automatic water top up - keeps your water at a constant level by replenishing water lost through evaporation and backwash
- Control Panel - our panels are build to your specification, giving you complete control at your fingertips
- Cleaning & Maintenance - we have a wide choice of manual and automatic cleaners and offer advice on regular maintenance

POLYPOOL PL18 indoor

This chart represents the total heat lost in watts through the walls and floor.

pool section and surrounding conditions	conventional construction	Polypool 125mm thermal panel system
dry conditions (walls)	79 watts per m2 per hour	3.6 watts per m² per hour
dry conditions (floor)	27 watts per m2 per hour	5 watts per m² per hour
wet conditions (walls)	140 watts per m2 per hour	3.6 watts per m² per hour
wet conditions (floor)	97 watts per m2 per hour	5 watts per m² per hour

Heat loss is a key factor when planning and running a swimming pool. Restricting heat loss through the walls & flooring is essential in the economic running of a pool.



Environmental control system



Control panel



POLYTILE

Indoor and outdoor pools

THE WORLD'S FIRST HEAT RETAINING TILED POOL

Our Polytile system benefits from the same technology used in all our pool structures so you can expect the same great cost savings, along with the added durability and extended life expectancy of a tiled finish. We offer a range of colours and patterns for you to choose from and a selection of tiled motifs are available to compliment your chosen tiles.

The Polytile system is ideal for commercial applications and domestic pools which require a more durable finish and is perfect

for hydrotherapy pools where a higher water temperature is required. Our tiled option can be supplied as a DIY kit or as part of a complete design and installation service for both indoor and outdoor pools.

All our indoor tiled pools comply with new Part L building regulations.

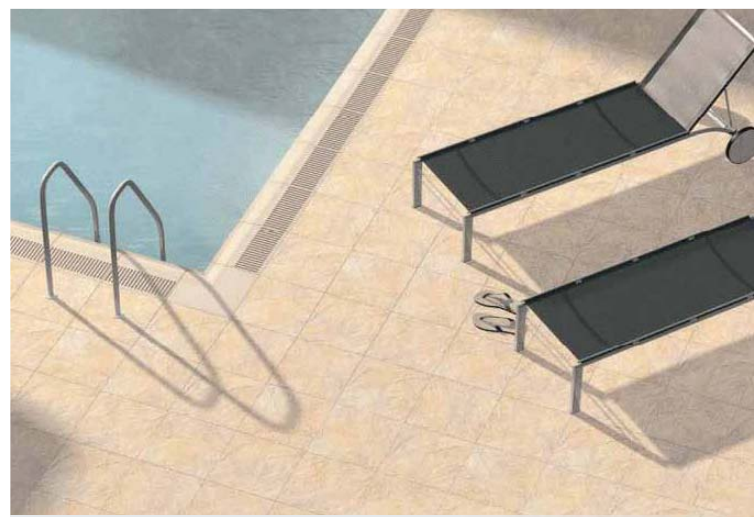
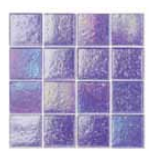
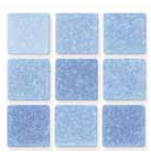

Beautiful, durable and long lasting



Polytile - complete insulated pool structure with tiled finish

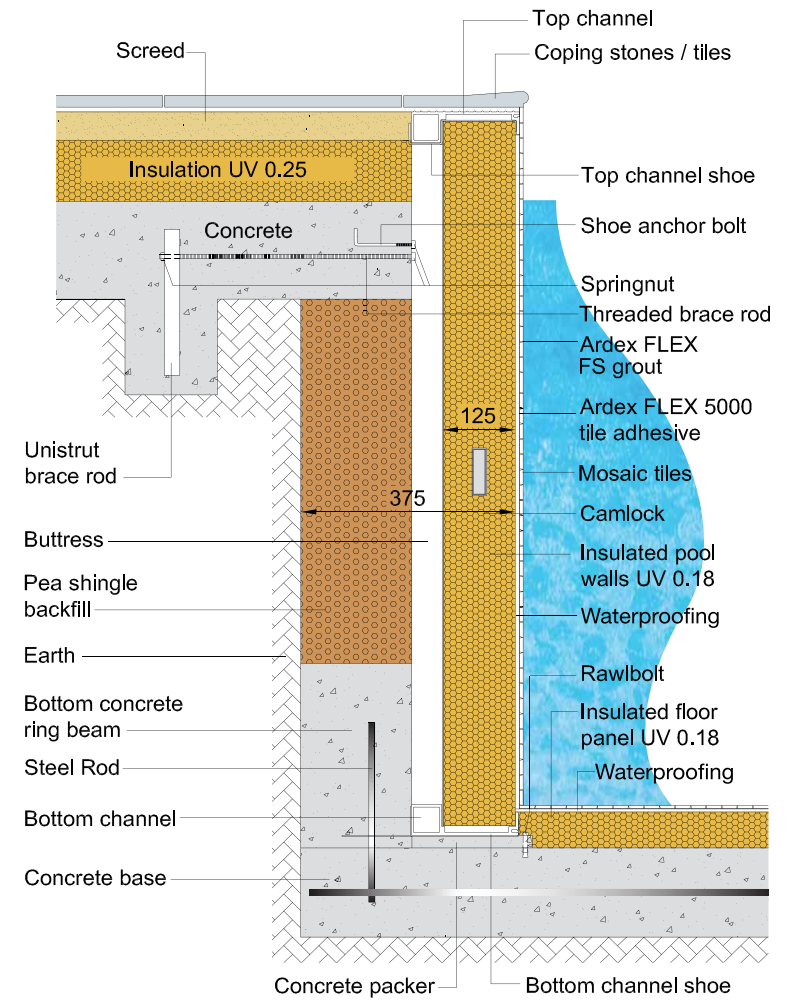

Liner Patterns

All our liners are manufactured in the UK to the highest specification and every detail is considered using the finest quality vinyl materials formulated especially to withstand the swimming environment for many years. The material gives maximum protection against ultra-violet degradation, chemical attack and contamination from bacteria or fungi.

Polypool offer three grades of liner, ranging from the industry standard 0.5mm thickness to the more durable On-site welded liner range which is used mainly for commercial pools and heavily used swimming pools. The life span ranges from 8 - 20 years.

Standard Domestic Liners

0.5mm Standard liner (20Thou). This liner is included with all our Polypool kits as standard. *0.75mm Upgraded liner (30Thou).* The upgraded liner is manufactured in the same way as a standard liner but using a thicker material which makes it even more durable and long-lasting.

Heavy Duty/Commercial Liner

1.5mm On-site welded liner. The strength of our commercial on-site welded liner is exceptional. With the reinforced thicker material it can withstand intensive use and is ideal in a commercial environment or heavily used domestic pool. This includes a UV stabilizing treatment and can withstand exposure to extreme changes in weather and temperature.

Tile Band Options

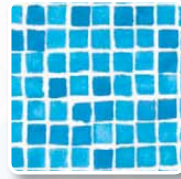

Liner Options

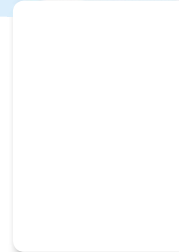
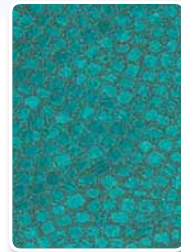
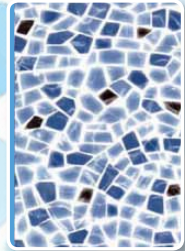
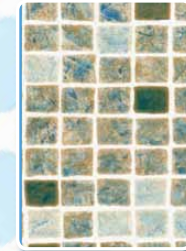
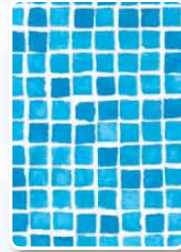

Contemporary Liner Options

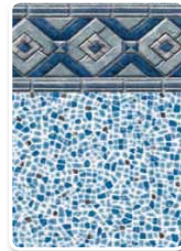

Polypool optional extras



Safety pool covers



LED under water lighting

Polypool have carefully selected a range of optional extras which compliment our pool kits. We can offer you a wide choice of steps, lighting, heating, covers, copings and much more to cater for all aspects of your pool project and enable you to tailor your pool to create the swimming environment required, whether it be a small domestic outdoor pool or commercial indoor installation.



Manual pool roller & solar covers

For all your swimming pool accessories please visit www.diypoolstore.co.uk



POLYROOMS™

THE NEXT GENERATION BUILDING CONCEPT

The Polyroom concept offers an affordable and efficient method of construction to rival any other garden room and is the perfect environment for an indoor pool.

With our extensive research and development, combined with our previous experience working with insulated panels we have designed a range of outdoor rooms which are quick to build, low maintenance and heat retaining. Our design focus is on using highly energy efficient materials with excellent insulation properties.

We manufacture our garden buildings to the highest standards in our purpose built, highly efficient production facility. This enables us to produce our buildings at a cost effective price, supplying direct from our factory to your garden.

Polyrooms are available in a range of designs with a choice of windows and doors giving you the environment you need in which to work, rest or play, regardless of the weather. They can be used as pool halls, garden offices, studios, music rooms, and many more when you don't have the room indoors.

We will help you to design, plan and install your perfect garden room and can offer architectural services and assist with any planning issues.





The Polyroom concept is ideal for:

- Pool Hall
- Plant Room
- Music Room
- Gym
- Office
- Summer House
- Playroom
- Garden Room
- Hobby/craft room



Music Room



Home Office



Home Gymnasium



Research has shown that chlorine and other halogens do not guarantee the total destruction of all bacteria in pool water.

Most people have some reaction to the chlorine in pool water - red and sore eyes, dry and damaged hair and skin. Sufferers from asthma, allergies and sinus problems are often only able to swim for a very short time, if at all. And there is always the danger of infection including widespread and dangerous cryptosporidium.

The Polypure purification system works by the electronic oxidation of the water which produces pure oxygen inside a sealed chamber within the water stream. The water molecule itself is split into Atomic Oxygen (O_1), Oxygen (O_2), Hydroxyl ion (OH) and Hydrogen Peroxide (H_2O_2).

The pH level is controlled by a CO_2 injection into the water which eliminates the need for harmful acid, making it one of the safest systems on the market.





The benefits

- No salt
- No chlorine
- No toxins
- No Trihalomethane gas
- Prevents algae or bacteria
- Protects your investment
- Less frequent filter and sand replacement
- Pumps last longer
- Not harmful to eyes, skin and hair
- Prevents infection

The result is that there are no unhealthy side effects and we encourage water testing by approved laboratories. Multiple chambers of oxygen electrodes are designed to deliver a steady amount of oxidation per minute

per chamber (depending on water volumes). Combined with ionic copper residual this contributes to the destruction of waterborne pathogens and by adding UV, even dangerous cryptosporidium.



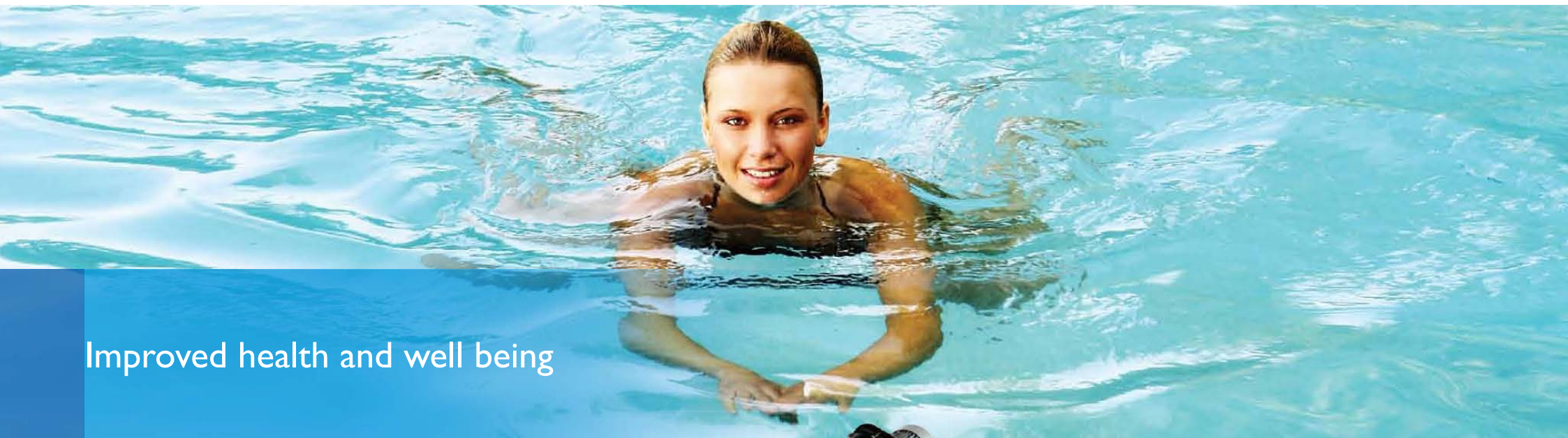

Improved health and well being

C O U N T E R C U R R E N T U N I T S

Whether you are a professional swimmer or looking to enjoy some exercise at home a counter current unit is the perfect solution and we have a range of units to cater for all requirements.

Swimming has long been recognised as one of the most effective forms of exercise. Whether it is part of a daily training programme or for gentle exercise a counter current unit in an exercise pool can be tailored to give you the ideal swimming environment.

The counter current unit, which can be easily fitted to most in-ground pools, produces a resistant current in the water for you to swim against without actually going anywhere! Just like a water treadmill - so with limited space you can swim for miles in the same spot!

Our units can either be fitted into an existing pool or can be built into a Polypool kit during construction. An exercise pool can provide the benefits and fun of a full size swimming pool at a fraction of the cost.



A small exercise pool can either be installed into an existing space, like a garage or existing spare room, or can be housed in a purpose built pool house or enclosure allowing you to exercise all year round regardless of the weather. With a smaller pool the heating and maintenance costs are also greatly reduced and are comparable to running a hot tub.

Our exercise pools are simple to install, easy to maintain and cost effective to run.

If you are limited for space and access our Polypool kits fitted with a counter current unit are the ideal way to create your own fitness facility.

H Y D R O T H E R A P Y P O O L S

Hydrotherapy is a therapeutic whole-body treatment that involves moving and exercising in water - physiotherapy in a pool. Hydrotherapy pools differ from ordinary pools whereby the temperature, pressure and movement of water is controlled and changed according to who's using the pool.

Being immersed, buoyant or massaged in water can help relieve many symptoms in a variety of different ways and hydrotherapy can help with many physical and emotional complaints including:

- anxiety and stress
- headaches
- back pain
- anxiety and stress
- muscle pain and inflammation
- hip or other joint replacements (before and after operations)
- muscle or ligament injuries; broken limbs



SETTING THE STANDARD IN INSULATED POOL MANUFACTURING



Chemical mixing station

Polypool take pride in their history and thorough design. The swimming pool system that we have pioneered has not only made Polypool the technological leader in panel pool manufacturing but has also delivered the most efficient method of pool construction available today.

All Polypool panels are engineered to the highest standard in our UK based factory using the latest technology in high pressure polyurethane injection.

Polypool is the only insulated panel pool system in the world made using this kind of process.

We welcome factory visits from all our customers. Come and see for yourself how the world's only insulated swimming pool structure is manufactured.

We set the standard.



Unique panel jig to create all sizes